

SERIES PE100

2 way normally closed angle seat valve pneumatically operated.
Inlet under seat.

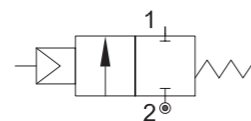

OVERALL DIMENSION

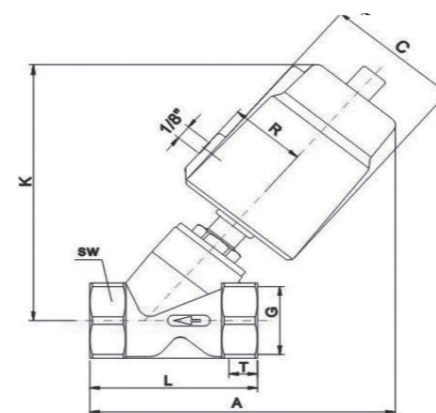

PRESENTATION

Compact valve
Water hammer effect prevention (inlet under seat)
Protected visual position indicator
PTFE sealing pack
NPT thread on request
Maintenance free sealing pack
Normally open version available on request
Double acting version available on request
Pilot thread: G1/8" (G1/4" for 125 mm actuators)
Universal mounting position

VALVE FEATURES

FLUID PRESSURE	Up to max 16bar
CONTROL PRESSURE	from 3.5bar (see table)
CONTROL FLUID	Neutral gas, Air
BODY MATERIAL	Stainless steel AISI 316
SEALING	PTFE
ACTUATOR MATERIAL	AISI 304 or Aluminium (125 mm)
ACTUATOR SIZE	40mm, 50mm, 63mm, 90mm, 125mm
FLUIDS	Water, Alcohol, Oils, Fuels, Steam, Natural gases or Liquids, Organic solvents, Acids and Lyes
FLUID VISCOSITY	Max 600cSt (mm2/s)
FLUID TEMPERATURE	-10°C to +180°C
AMBIENT TEMPERATURE	-10°C to +80°C
CONTROL TYPE	Normally closed, (on request Normally open, Double acting)

CONNECTION	Threaded (NPT, BSP)
------------	---------------------

USE	Packaging, Drinks Filling Machinery, Textile printing, Pharmacy & Medical Equipment, Chemical industry, Foaming Equipment, Water/sewage Disposal
-----	--

CODE	ACTUATOR	DN	PILOT PRESSURE	MAX PRESSURE	Q	C	R	K	THREADED CONNECTION				
									G	T	A	L	SW
		[mm]	[bar]	[bar]		[mm]	[mm]	[mm]		[mm]	[mm]	[mm]	[mm]
PE140CGW10/V	Ø40	DN10	4	0 - 13	G1/8"	50.5	27	112	G3/8"	12	124	68	27
PE150CGW10/V	Ø50	DN10	4.5	0 - 14	G1/8"	60	33	125			135		
PE140DGW15/V	Ø40	DN15	4	0 - 13	G1/8"	50.5	27	112	G1/2"	12	124	68	27
PE150DGW15/V	Ø50	DN15	4.5	0 - 14	G1/8"	60	33	125			135		
PE150EGW20/V	Ø50	DN20	4.5	0 - 14	G1/8"	60	33	132	G3/4"	16	140	75	32
PE150FGW25/V	Ø50	DN25	4.5	0 - 8	G1/8"	60	33	136			150		
PE163FGW25/V	Ø63	DN25	5	0 - 13	G1/8"	75	41	162	G1"	17	172	90	40
PE190FGW25/V	Ø90	DN32	3.5	0 - 14	G1/8"	106	55	223			235		
PE163GGW32/V	Ø63	DN32	5	0 - 6	G1/8"	75	41	174	G1 1/4"	21	190	116	50
PE190GGW32/V	Ø90	DN32	6	0 - 16	G1/8"	106	55	223			235		
PE163HGW40/V	Ø63	DN40	5	0 - 5	G1/8"	75	41	175	G1 1/2"	21	190	116	56
PE190HGW40/V	Ø90	DN40	6	0 - 16	G1/8"	106	55	223			235		
PE163IGW50/V	Ø63	DN50	5	0 - 3	G1/8"	75	41	183	G2"	22	205	138	69
PE190IGW50/V	Ø90	DN50	6	0 - 10	G1/8"	106	55	232			250		
PE190MGW65/V	Ø90	DN65	6	0 - 6	G1/8"	106	55	265			285	178	85
PE1125MGW65/V	Ø125AL	DN65	5.5	0 - 9	G1/4"	170	85	315	G2 1/2"	26	327		
PE1125RGW80/V	Ø125AL	DN80	5.5	0 - 5	G1/4"	170	85	327	G3"	27	380	210	100