

SERIES PM100

2 way bi-stable (double acting) pneumatically operated valve.
Modular assembling.

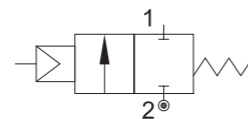

OVERALL DIMENSION

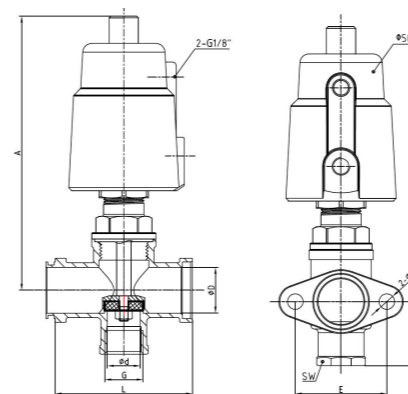

PRESENTATION

Best choice for fluid mixing
Flanged connection modularity
Water hammer effect prevention
PTFE sealing pack
Maintenance free sealing pack
Pilot thread: G1/8"
Universal mounting position

VALVE FEATURES

FLUID PRESSURE	Up to max 14bar
CONTROL PRESSURE	from 4.5bar (see table)
CONTROL FLUID	Neutral gas, Air
BODY MATERIAL	Stainless steel AISI 316
SEALING	PTFE
ACTUATOR MATERIAL	AISI 304
ACTUATOR SIZE	50mm
FLUIDS	Water, Alcohol, Oils, Fuels, Steam, Natural gases or Liquids, Organic solvents, Acids and Lyes
FLUID VISCOSITY	Max 600cSt (mm ² /s)
FLUID TEMPERATURE	-10°C to +180°C
AMBIENT TEMPERATURE	-10°C to +80°C
CONTROL TYPE	Double acting (/NC and /NO)

CONNECTION KIT

Inlet plate (plate+OR+screws+nuts) Female cod.14913000
Modules connection kit (OR+screws+nuts) cod.14914000
End plate (plate+OR+screws+nuts) Male cod.14915000
Threaded connection kit available on request

CONNECTION	Threaded (BSP, NPT)
------------	---------------------

USE

Packaging, Drinks Filling Machinery, Textile printing, Pharmacy & Medical Equipment, Chemical industry, Foaming Equipment, Water/sewage Disposal

OPTIONS

Normally closed and normally open versions (add /NC or /NO to the valve code)

CODE	DN (ØD)	PILOT PRESSURE	MAX PRES-SURE	A	L	K	2-ØF	E	ØD	Ød	G	SW
	[mm]	[bar]	[bar]	[mm]	[mm]	[mm]	[mm]	[mm]	[mm]	[mm]		[mm]
PM150DGW15/V	DN20	4.5	0 - 14	153	76	35	8.5	50	25	18	1/2"	27
PM150FGW25/V	DN25	4.5	0 - 8	153	90	46	8.5	57	32	24	1"	39

Ordination example:

PM150XGW20/V to order an ASV 2/2 Double effect, Outlet threaded G3/4", PTFE sealing, with visual indicator

PM150XGW20/V/NC to order an ASV 2/2 Normally closed, Outlet threaded G3/4", PTFE sealing, with visual indicator