

SERIES PT100

2 way normally closed angle seat valve pneumatically operated.
Inlet under seat. Tri-Clamp connections.

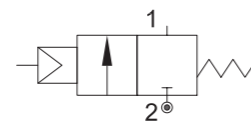

OVERALL DIMENSION

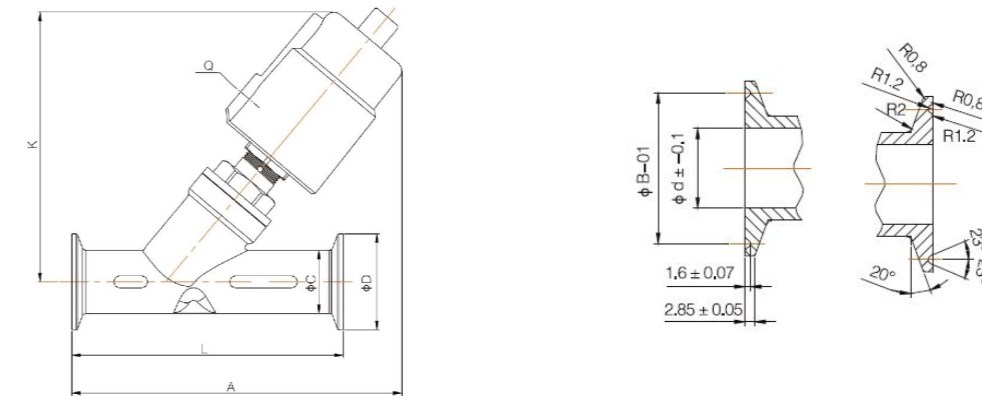

PRESENTATION

Welded Socket Valve Acc. to DIN 11850-2
Optional Socket Valve Acc. to DIN 11850-3
Water Hammer effect prevention (inlet under seat)
Protected visual position indicator
PTFE sealing pack
Maintenance free sealing pack
Double acting version available on request
Normally open version available on request
Pilot thread: G1/8" (G1/4" for 125 mm actuators)
Universal mounting position

VALVE FEATURES

FLUID PRESSURE	Up to max 16bar
CONTROL PRESSURE	from 3.5bar (see tables)
CONTROL FLUID	Neutral gas, Air
BODY MATERIAL	Stainless steel AISI 316
SEALING	PTFE
ACTUATOR MATERIAL	AISI 304 or Aluminium (125 mm)
ACTUATOR SIZE	40mm, 50mm, 63mm, 90mm, 125mm
FLUIDS	Water, Alcohol, Oils, Fuels, Steam, Natural gases or Liquids, Organic solvents, Acids and Lyes
FLUID VISCOSITY	Max 600cSt (mm ² /s)
FLUID TEMPERATURE	-10°C to +180°C
AMBIENT TEMPERATURE	-10°C to +80°C
CONTROL TYPE	Normally closed (on request Normally open, Double acting)

CONNECTION	Welded Acc. to DIN 11850-2
-------------------	----------------------------

USE	Packaging, Drinks Filling Machinery, Textile printing, Pharmacy & Medical Equipment, Chemical industry, Foaming Equipment, Water/sewage Disposal
------------	--

CODE	ACTUATOR [mm]	DN [mm]	PILOT PRESSURE [bar]	MAX PRESSURE [bar]	Q [mm]	A [mm]	K [mm]	TRI-CLAMP CONNECTION				
								L [mm]	C [mm]	B [mm]	Ød [mm]	ØD [mm]
PT140DGW15/V	Ø40	DN15	4	13	G1/8"	130	115	80	19	27.5	15	34
PT150DGW15/V	Ø50		4.5	14	G1/8"	140	126	80	19	27.5	15	34
PT150EGW20/V	Ø50	DN20	4.5	14	G1/8"	148	126	102	25	43.5	21	50.5
PT150FGW25/V	Ø50	DN25	4.5	8	G1/8"	165	140	130	32	43.5	27	50.5
PT163FGW25/V	Ø63		5	13	G1/8"	188	166					
PT163GGW32/V	Ø63	DN32	5	6	G1/8"	200	174	146	37	43.5	31	50.5
PT163HGW40/V	Ø63	DN40	5	5	G1/8"	210	175	160	40	56.5	33	64
PT163IGW50/V	Ø63	DN50	5	3	G1/8"	221	185	175	53	56.5	45	64
PT190IGW50/V	Ø90	DN50	6	10	G1/8"	265	235					